

# SHOPS AT SHILOH CROSSING

3940 CHEROKEE STREET, KENNESAW, GA 30144



## PROPERTY DETAILS

- 40,767 SF retail center in Cobb County
- 4,000 SF restaurant endcap available, 2,400 SF former hair salon space available, and 2,800 SF inline space available
- High traffic counts on Cherokee Street with 35,100 VPD, and with immediate access to I-75
- Convenient ingress and egress; new signal at the main entrance coming soon
- 1 mile from rapidly-expanding Kennesaw State University in Cobb County
- Strong demographics, City of Kennesaw is experiencing explosive growth
- Surrounding retailers include Home Depot, Starbucks and Kroger

**BRAND**  
*Real Estate Services*

BrandProperties.com  
770.476.4801

# SHOPS AT SHILOH CROSSING

3940 CHEROKEE STREET, KENNESAW, GA 30144



## TRAFFIC COUNTS

Cherokee Street 35,100 VPD  
I-75 121,900 VPD

## DEMOGRAPHICS - 2018 CoStar

	1 mile	3 miles	5 miles
Population	11,316	75,927	181,794
Income	\$71,031	\$85,785	\$85,300

## GPS COORDINATES

Lat. 34.048713 Long. -84.596745

## TENANTS

101	Green Dry Cleaners	2,112 SF
102	Coming Soon: Boost Mobile	1,550 SF
103	Mediterranean Bistro	2,000 SF
104/105	Johnny's NY Pizza	2,550 SF
<b>201</b>	<b>Available former hair salon space that can be subdivided</b>	<b>2,400 SF</b>
301	Mazzy's Sports Bar & Grill	9,430 SF
401/402	Discover Chiropractic	2,800 SF
403	Metro PCS	1,400 SF
<b>404/405</b>	<b>Available</b>	<b>2,800 SF</b>
406	Classic Monograms	1,400 SF
407	Accuquest Hearing Center	1,400 SF
501	Dynamite Dance Factory	1,450 SF
502	ATA Karate	5,475 SF
<b>601</b>	<b>Donny's Home Cooking / Available</b>	<b>4,000 SF</b>

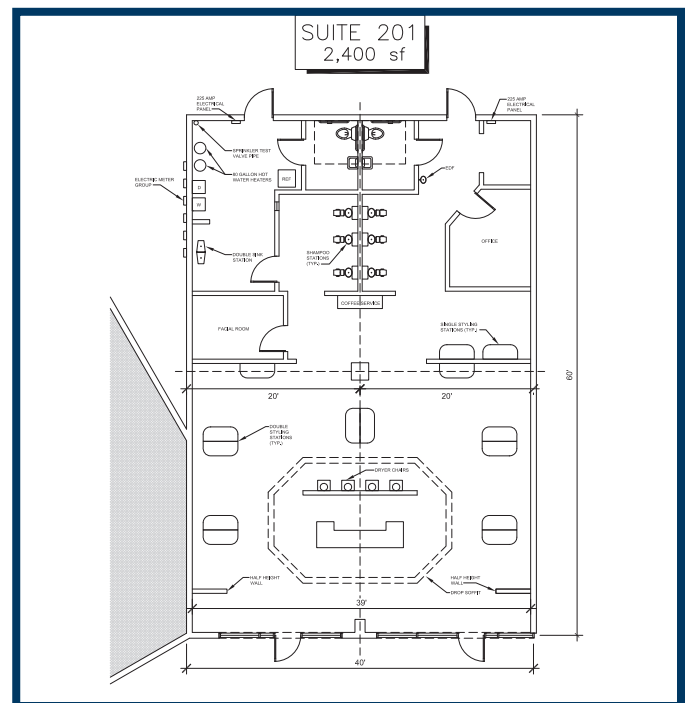

**Michael Walker, CLS**  
Vice President, Leasing

[mwalker@BrandProperties.com](mailto:mwalker@BrandProperties.com)

770.623.2080 Direct | 401.480.0863 Mobile

**BRAND** Real Estate Services

1960 Satellite Boulevard, Suite 1300 Duluth, GA 30097 770.476.4801